



神田家

Kanda house



Flagstone doji
(Entrance)

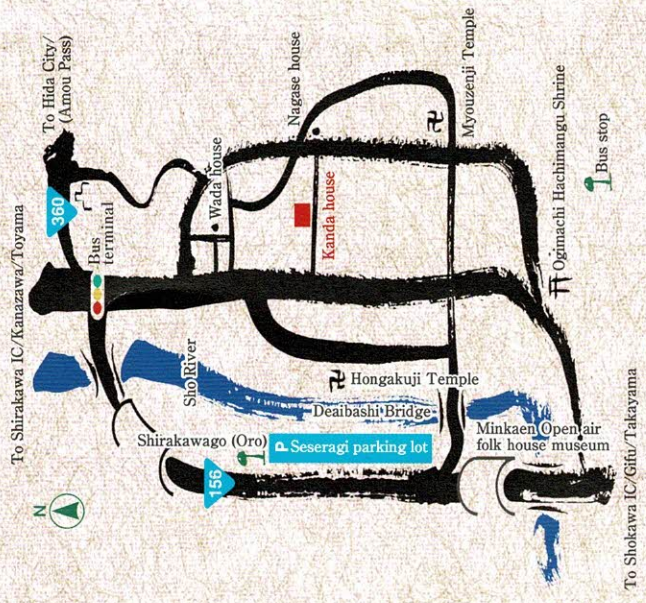
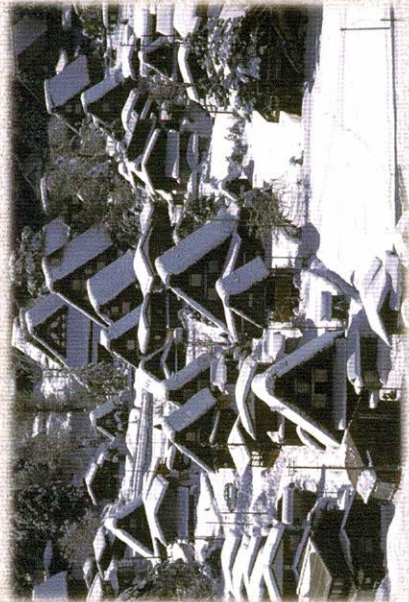

- Opening hours: 9:00 a.m. to 5:00 p.m.
- Closure day: Irregular ※ Closed: Wednesdays (From December to February)

神田家

796 Ogi-machi Shirakawa-Village Ohno-District Gifu Pref.501-5627
Tel:05769-6-1072 Fax:05769-6-1704
<http://kandahouse.web.fc2.com/> e-mail:kanda-ke@css.jp

Shirakawago and Kanda house

The Gassho style settlement in Shirakawa Village located at the headstream of the Shio River in northern Gifu prefecture was registered as UNESCO World Heritage in December, 1995 (Heisei 7). It is reported that the pattern of Ogimachi Town with the largest number of Gassho style houses existing, which is 114, among the settlements registered as world heritage, was already formed in the beginning of the Middle Ages and prospered by entry of Yamashita Ujikatsu, the lord of Ogimachi castle, who is Uchigashima Ujimasa's general, into this Shirakawago in 1460 (Kan'ei 1).

The Kanda family started when Wada Yaemon, the second son of the Wada house (designated as a national important cultural property) located himself in that region as a branch family. In those days, there existed a "Kanda" (divine rice field) of Ubusuna Hachimangu Shrine, so he changed his family name to Kanda and succeeded to Kanda Kichiemon's name.

This Gassho-style Kanda house is said to have been built over a period of ten years by a Miya daiku or shrine carpenter from Ishikawa prefecture during the latter half of the Edo period. It is described as a high-quality finished Gassho-style house which adopts new techniques to make improvements while observing the previous structure of Gassho style.

The Gassho-style houses were mainly engaged in "Raising silkworms", and besides that, the Kanda family made "Fuming nitric acid" which is an ingredient of gunpowder under floor to earn rare hard cash.

The Gassho-style houses are suitable not only for a whole family to live in but also for labor-intensive occupation such as raising silkworms and making fuming nitric acid to be carried out. The German architect Bruno Taut, who visited Shirakawa Village in 1935 (Showa 10), highly appreciated the Gassho-style houses for their rationally and logically unique structures.

Hasagura (grain-drying shelter)



4th floor

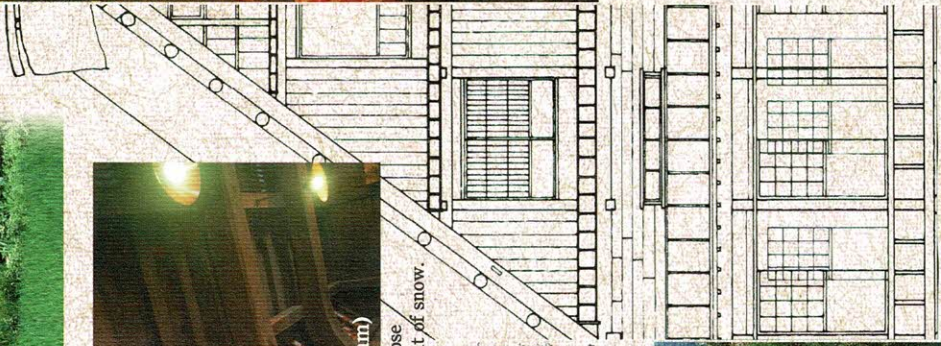

Chonabari (Curved beam)

Beams made up using strong trees whose bases grew up curved under the weight of snow.

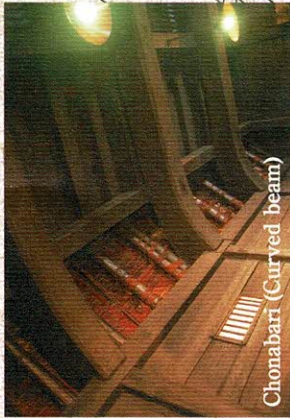

Ryuujinsama (Dragon divinity)

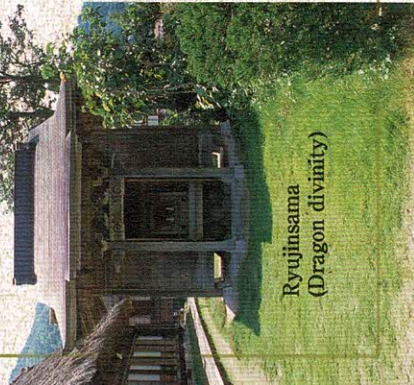

Live together with antiquities.
Live with ancient wisdoms.



Irori fireplace

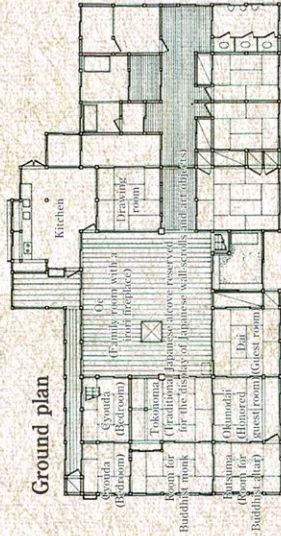

Karaisu (crusher) house

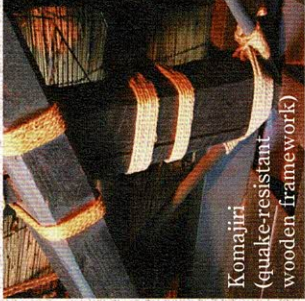

Komajiri (quake-resistant wooden framework)

Materials that support the Gassho-style roof and disperse the force applied on the roof when a strong wind blows or an earthquake occurs.

The wisdom for quake resistance, fire protection, measures against snow and ice, etc. Learned from living life over a period of time lies in the "Gassho style" architecture.

Shirakawago is even now breathing heritage in combination with succession, preservation and living life.



Second-floor exhibition hall



Fire watch window on the mezzanine floor
Small window for watching out for fire in the irori fireplace



Mezzanine floor

